

# UTILITY BOXES

**SERIES  
1800**

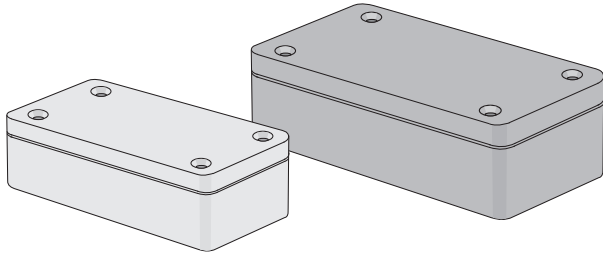

This series of utility boxes is very suitable for assembling of in-door electronic devices. Furthermore they are ideal for complete or partial potting.

Moulded in ABS UL94-VO and as standard delivered in grey or black. Other colours are available upon request.

Two different sizes are all easily assembled by means of self tapping screws.

Can be supplied drilled, printed, EMC coated, etc. according to customer specification.

Type	Dimensions outside: mm.			Dimensions inside: mm.			Material	Assembly	Order Code:	
	Length	Width	Height	Length	Width	Height			Method	Grey
B105025	100	50	25	94	44	19	ABS	Screw	4910502501	4910502502
B 105040	100	50	40	94	44	34	ABS	Screw	4910504001	4910504002

# SEALED HANDHELD ENCLOSURES

**SERIES  
3000**

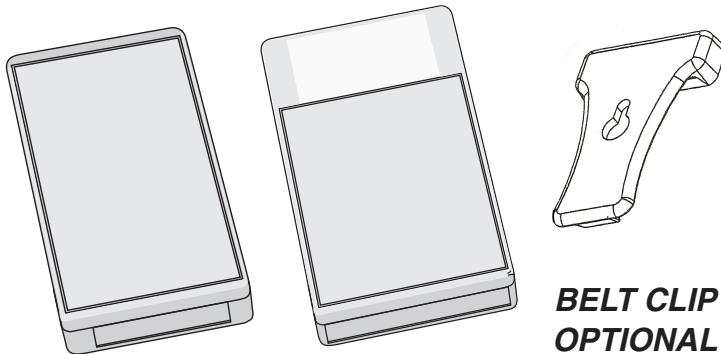

**BELT CLIP  
OPTIONAL**

**TYPE 3001**  
Size: 130x68x25

**TYPE 3041**  
Size: 160x85x30

### TYPE 3001 AND TYPE 3041

This series is designed for remote controllers, measuring devices, hand-held control devices, portable data recorders and other fields of electronics.

Large smooth recessed area for membrane switches or label.

Customization available for display window and switch button hole. Each with battery cover

### TECHNICAL DATA:

Top part: ABS  
Base part: ABS  
Colour: Grey or black  
Temperature range: -40 - +75°C  
Self-extinguishing: UL94-VO  
Sealing: IP65 / (IEC529)

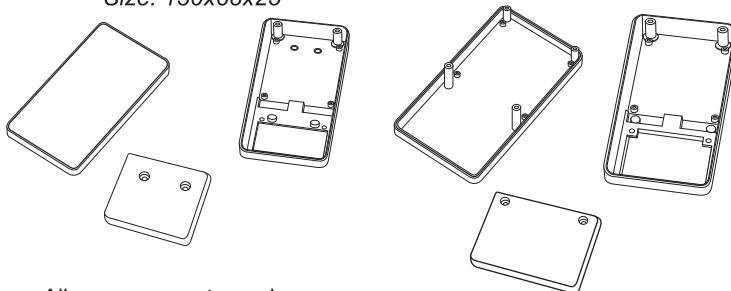

● All measurements are in mm.

Technical drawings available on: [www.bernic.dk](http://www.bernic.dk)

SERIES 3000:	ORDER CODE:
Type 3001, grey, sealed	p/n 4969883001
Type 3001, black, sealed	p/n 4969863001
Type 3041, grey, sealed	p/n 4969883041
Type 3041, black, sealed	p/n 4969863041
Belt clip, grey	p/n 4969300001
Belt clip, black	p/n 4969300002